

HS 50

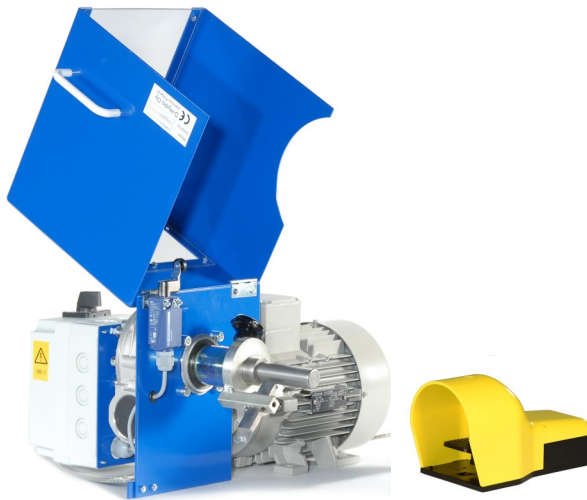

TECHNICAL SPECIFICATIONS

Max hose size	2" (internal & external)
Standard motor	1,1 kW 400V 3-Ph
Different voltage versions available	
Control	Footpedal
Blade speed	150 rpm
Weight (kg)	25
Dimensions (LxWxH mm)	460 x 490 x 270

Optional SKIVING HEADS

External size	Range (mm)
3/16"	20-55
1/4"	20-55
5/16"	20-55
3/8"	20-55
1/2"	20-55
5/8"	20-55
3/4"	20-55
1"	30-90
1 1/4"	30-90
1 1/2"	30-90
2"	30-90
Internal size	Range
3/8"	adjustable ↔
1/2"	adjustable ↔
5/8"	adjustable ↔
3/4"	adjustable ↔
1"	adjustable ↔
1 1/4"	adjustable ↔
1 1/2"	adjustable ↔
2"	adjustable ↔



Skiving heads are sold separately

WWW.DHYDRO.COM

Wahlforssinkatu 10 - 80100 Joensuu - Finland - Tel. +358 13 120 490 - info@dhydro.com

GENERAL INSTRUCTIONS

Hose skiving machine HS 50 F is a compact desktop machine for internal and external skiving the top rubber layer of a hydraulic hose.

SAFETY PRECAUTIONS



Do not use the machine without reading and understanding this manual!



The machine has been designed for skiving hydraulic hoses only! Do not use for other purposes!

Use only original D-Hydro skiving heads!

Never touch the rotating skiving head!

Do not modify safety or operation devices!

INSTALLATION INSTRUCTIONS

The machine has to be installed on a solid desk. **The front edge of the cover must be on the same level as the edge of the table.** See point A. This is for safety reasons, otherwise it would be possible to touch the rotating skiving head underneath the cover. Attach the machine to the table by M8 bolts from the holes of the motor. See point B.



ELECTRICAL CONNECTION AND ROTATION DIRECTION CHECK

NOTE! Only an authorized electrician is allowed to do the following operations!

1. Check whether the machine voltage and the supply voltage are the same
2. Connect the cable to the power supply
3. Close the cover (4)
4. Turn the rotation change switch (1) to position "1"
5. Start the motor with foot pedal (5). **Do not touch the rotating skiving head!**
6. **Make sure that the skiving head rotates clockwise (internal skiving)**
7. **If the motor rotates in wrong direction, switch the electricity wires from the cable L1 to L2 and from L2 to L1 (See electric diagram)**

INSTALLATION AND OPERATION DEVICES

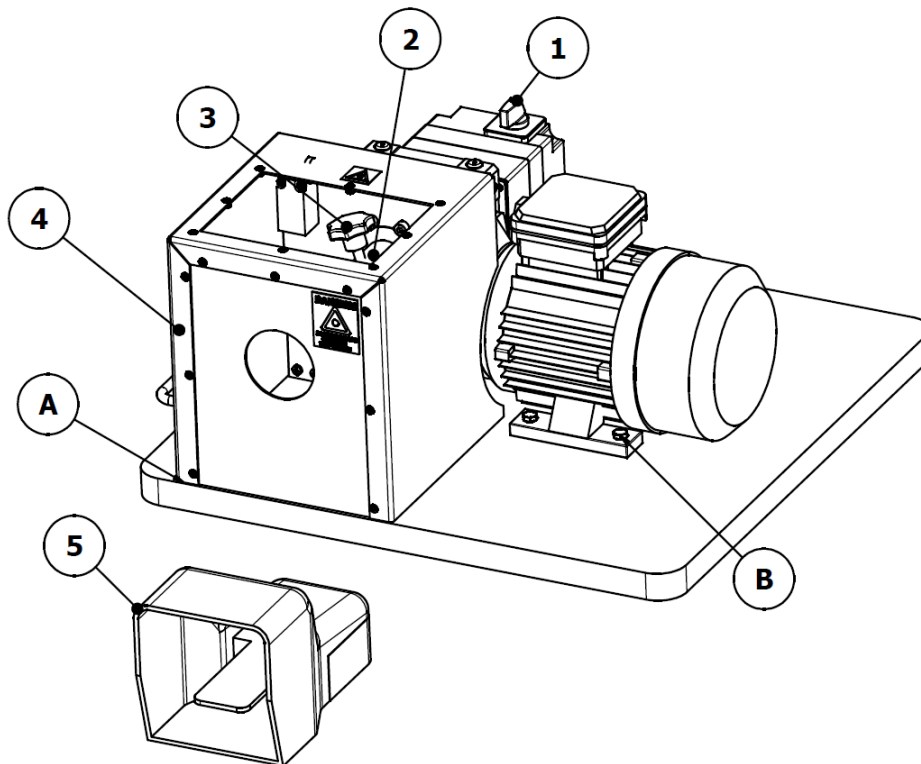

A. DESKTOP INSTALLATION

The front edge of the cover must be on the same level as the edge of the table

B. FIXING BOLTS

Attach the machine to the table by 4pcs of M8 bolts and nuts.

1. MAIN AND DIRECTION CHANGE SWITCH

0- Position: main power off

AFTER USAGE, LEAVE THE SWITCH ALWAYS TO 0-POSITION!

1- Position clockwise: internal skiving

2- Position counter clockwise: external skiving

2. SKIVING HEAD FASTENER

3. HAND KNOB

4. COVER

5. FOOT PEDAL

The pedal is equipped with a safety latch to prevent misuse of the pedal



MACHINE IDENTIFICATION AND WARNING LABELS

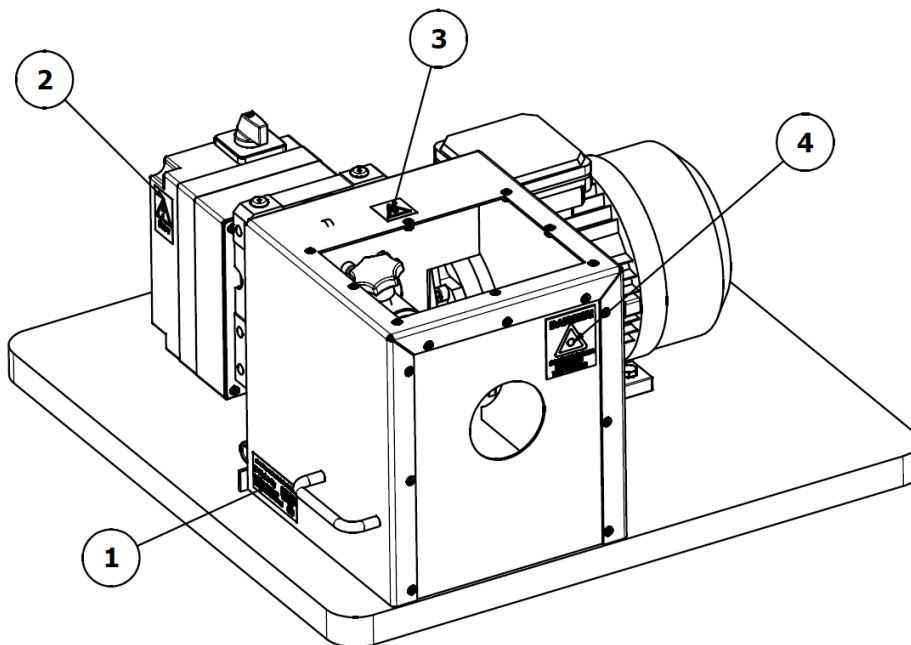

Warranty & spare parts



1: Machine plate: Machine type, model, serial number, year of manufacture.
Manufacturer and address.



2: High voltage. Only an authorized electrician is allowed to open the electric box.



3: Keep hands away from the rotating tool.



4: Do not put hands or fingers into the hole of the cover.

ADJUSTING THE SKIVING HEADS

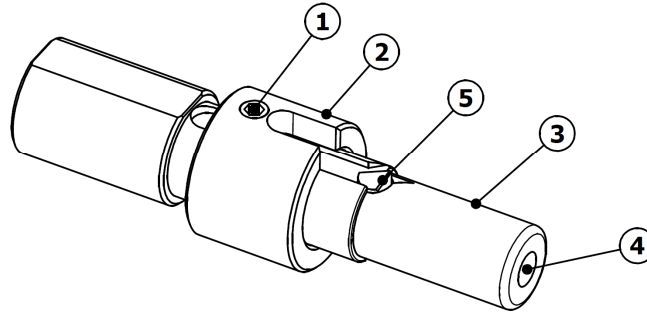

Internal skiving head

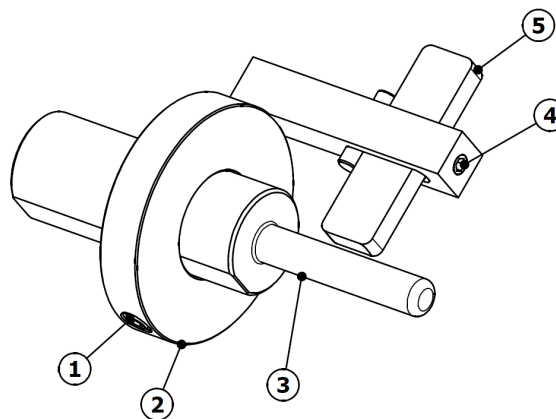

External skiving head

1. **Screw to lock the skiving length**
2. **Bushing to set the skiving length**
Loose the locking screw (1) and adjust the skiving length with the bushing (2)
3. **Middle mandrel**
4. **Screw to lock the skiving depth**
5. **Blade**
Loose the locking screw (4) and adjust the skiving depth with the blade (5)



**These instructions are only for original D-Hydro skiving heads.
Do not use any other skiving tools!**

WORKING POINT

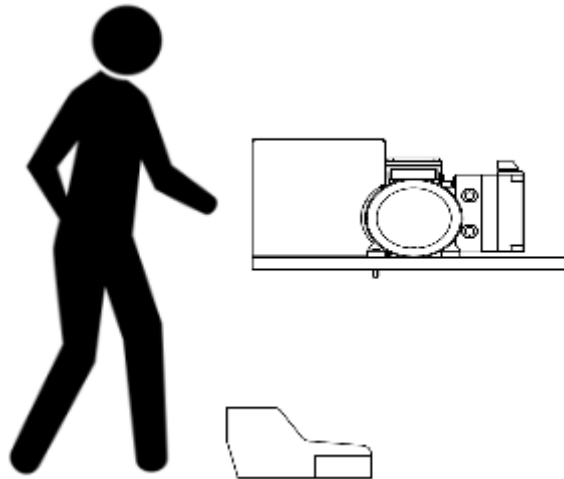

USING THE MACHINE

Turn the switch (1) to position 0

Open the cover and insert the skiving head inside the skiving head fastener, so that the flat side of the middle mandrel is below the hand knob. Tighten the hand knob.

External skiving: Turn the switch (1) to position 2, rotation direction counter clockwise

Internal skiving: Turn the switch (1) to position 1, rotation direction clockwise

Hold the hose firmly with your both hands. Start the machine with foot pedal. Note that the pedal has a safety latch to prevent misuse of the pedal! The latch must be pushed before the pedal can be used! Push the hose slowly into the middle mandrel until skiving is completed. Pull the hose away from the middle mandrel and release the pedal.

After usage, leave the switch (1) always to the 0-position!

MAINTENANCE

Keep the working area of the machine clean and in good order. Remove the skiving waste regularly inside the cover.

If the machine breaks down, contact D-Hydro Oy or your nearest authorized dealer.

TECHINAL SPECIFICATIONS:

Max hose size	2"
Standard motor	1.1 kW 380V 3ph
Blade speed	150 r/min
Control	Main and rotation direction change switch, foot pedal
Weight	25 kg
Dimensions (LxWxH)	460x490x270 mm
Noise dB (A)	Less than 72

ELECTRIC DIAGRAM

380V 3ph:

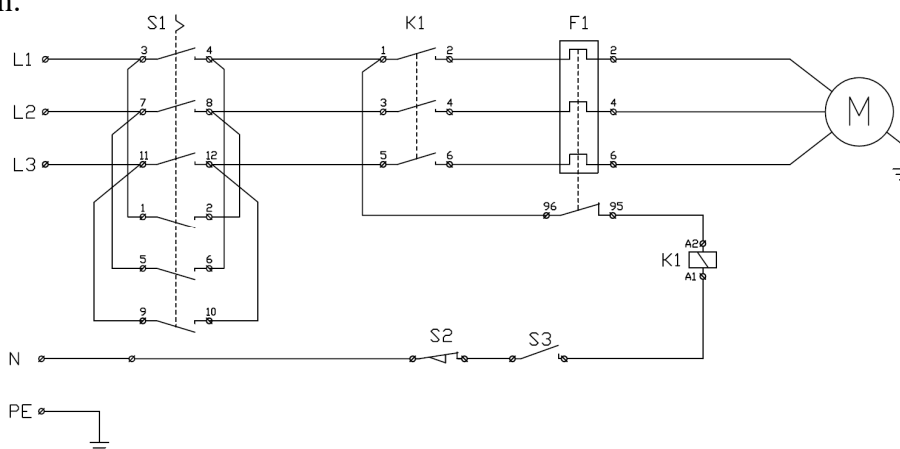

220V 3ph:

