

SERIE 69000

New

RACCORDI A COMPRESIONE IN ACCIAIO INOX AISI 316L
 STAINLESS STEEL AISI 316L COMPRESSION FITTINGS
 KLEMMRINGVERSCHRAUBUNGEN AUS EDELSTAHL AISI 316L
 RACCORDE À BAGUES BICÔNE EN ACIER INOX AISI 316L
 RACORDAJE A COMPRESIÓN EN ACERO INOX AISI 316L
 CONEXÕES DE COMPRESSÃO EM AÇO INOXIDÁVEL AISI 316L



CARATTERISTICHE TECNICHE
 TECHNICAL CHARACTERISTICS
 TECHNISCHE ANGABEN
 CARACTÉRISTIQUES TECHNIQUES
 CARACTERÍSTICAS TÉCNICAS
 CARACTERÍSTICAS TÉCNICAS



Norma di Riferimento

Reference standard
 Entspricht der Norm
 Norme de référence
 Normativa de referencia
 Norma de referência

1907/2006
REACH ✓

2011/65/CE
RoHS ✓

EN ISO
 8434-1-2007

PED
 2014/68/UE

SILICON
 FREE



Compliance

NSF / ANSI 169 - 61 - 372

1935/2004/CE

DM 174

Trattamento anti grippaggio.
 Anti-seize treatment.
 Anti-seize behandlung.
 Traitement antigrippant.
 Tratamiento anti-gripante.
 Tratamento anti-grippagem.

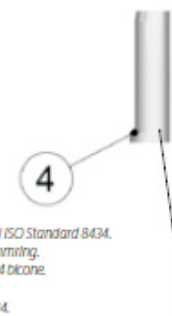
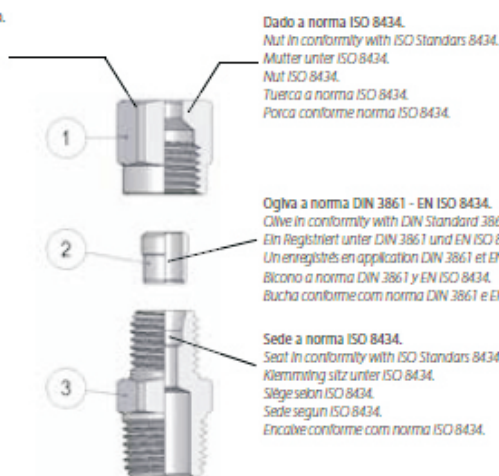

Rinforzo Art. 69770.
 Internal support bush Art. 69770.
 Verstärkung Art. 69770.
 Reinforcement Art. 69770.
 Refuerzo Art. 69770.
 Bucha de reforço interno Cód. 69770.

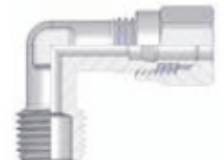

Materiali e Componenti	IT	Component Parts and Materials	GB	Komponenten und Materialien	DE
1 Dado In Acciaio Inox AISI 316L (1.4404) 2 Ogiva In Acciaio Inox AISI 316L (1.4404) 3 Corpo In Acciaio Inox AISI 316L (1.4404) 4 Rinforzo In Acciaio Inox AISI 304L (EN 1.4301)		1 Stainless Steel AISI 316L (1.4404) Nut 2 Stainless Steel AISI 316L (1.4404) Olive 3 Stainless Steel AISI 316L (1.4404) Body 4 Stainless Steel AISI 304L (EN 1.4301) Internal support		1 Überwurfmutter Edelstahl AISI 316L (1.4404) 2 Klemmring Edelstahl AISI 316L (1.4404) 3 Körper Edelstahl AISI 316L (1.4404) 4 Stützhülse Edelstahl AISI 304L (EN 1.4301)	
Matériaux et Composants	FR	Materiales y Componentes	ES	Materiais e Componentes	PT
1 Ecrou: Acier Inoxydable AISI 316L (1.4404) 2 Bague bicône: Acier Inoxydable AISI 316L (1.4404) 3 Corps: Acier Inoxydable AISI 316L (1.4404) 4 Fourrure Intérieure: Acier Inoxydable AISI 304L (EN 1.4301)		1 Tuerca en Acero Inoxidable AISI 316L (1.4404) 2 Bicono en Acero Inoxidable AISI 316L (1.4404) 3 Cuerpo en Acero Inoxidable AISI 316L (1.4404) 4 Refuerzo en Acero Inoxidable AISI 304L (EN 1.4301)		1 Porca em Aço Inoxidável AISI 316L (1.4404) 2 Bucha em Aço Inoxidável AISI 316L (1.4404) 3 Corpo em Aço Inoxidável AISI 316L (1.4404) 4 Reforço Interna em Aço Inoxidável AISI 304L (EN1.4301)	
Tubi di Collegamento	IT	Connection Tubes	GB	Geeignete Rohre	DE
Tubi in Inox, rame, ferro, acciaio, alluminio, ottone. Con apposito rinforzo interno (art. 69770), possono essere utilizzati anche tubi in PA, FEP, PTFE, ecc.		Tubes made in Stainless Steel, copper, steel, iron, aluminium, brass. With an inside support bush (art. 69770), can be used also for plastic material such as PA, FEP, PTFE, etc.		Rohre in Edelstahl, Kupfer, Eisen, Stahl, Aluminium, Messing. Mit einer internen Stützhülse (Art. 69770), können auch Rohre aus PA, FEP, PTFE, etc. verwendet werden.	
Tubes Conseillés	FR	Tubos de Conexión	ES	Tubos de Conexão	PT
Tubes en Acier Inoxydable, cuivre, acier, aluminium, laiton. Avec une fourrure Intérieure (art. 69770), les tubes plastiques PA, FEP, PTFE, etc. peuvent être utilisés.		Tubos en Acero Inoxidable, cobre, hierro, acero, aluminio. Con el correspondiente refuerzo interno (art. 69770), pueden utilizarse también con tubo en PA, FEP, PTFE, etc.		Tubos de Aço Inoxidável, cobre, ferro, aço, alumínio, latão. Com bucha de reforço Interna (cód. 69770), podem ser utilizados também com tubos em PA, FEP, PTFE, etc.	

69460

RACCORDO DIRITTO INTERMEDIO

STRAIGHT CONNECTOR
VERBINDUNGSVERSCHRAUBUNG
RACCORD UNION DOUBLE
RACOR RECTO INTERMEDIO
CONEXÃO RETA TUBO-TUBO

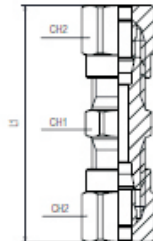

Code	Tube	L1	CH1	CH2	Pack.
69460 00 001	4	36	9	10	2
69460 00 002	6	36,5	11	12	2
69460 00 003	8	40,5	12	14	2
69460 00 004	10	48,5	17	19	2
69460 00 005	12	49,5	19	22	2

69480

RACCORDO DIRITTO MASCHIO

STRAIGHT MALE ADAPTOR
GERADE EINSCHRAUBVERSCHRAUBUNG KONISCH
RACCORD DROIT MÂLE CONIQUE
RACOR RECTO MACHO
CONEXÃO RETA COM ROSCA MACHO



Code	Tube	A	B	L1	CH1	CH2	Pack.
69480 00 001	4	1/8	7,5	27,5	10	10	2
69480 00 002	6	1/8	7,5	27,5	10	12	2
69480 00 003	6	1/4	11	32	14	12	2
69480 00 004	8	1/8	7,5	30	12	14	2
69480 00 005	8	1/4	11	33,5	14	14	2
69480 00 006	8	3/8	11,5	35	17	14	2
69480 00 007	10	1/4	11	38,5	16	19	2
69480 00 008	10	3/8	11,5	39,5	17	19	2
69480 00 009	12	3/8	11,5	40	18	22	2
69480 00 010	12	1/2	14	42,5	21	22	2

69485

RACCORDO DIRITTO MASCHIO CILINDRICO CON OR FKM

STRAIGHT MALE ADAPTOR WITH FKM OR
GERADE EINSCHRAUBVERSCHRAUBUNG KONISCH MIT OR FKM
RACCORD DROIT MÂLE CONIQUE AVEC OR FKM
RACOR RECTO MACHO CON FKM OR
CONEXÃO RETA COM ROSCA MACHO COM OR FKM



Code	Tube	A	B	L	CH1	CH2	Pack.
69485 00 001	4	1/8	6	26	13	10	2
69485 00 002	6	1/8	6	26	13	12	2
69485 00 003	6	1/4	8	28	15	12	2
69485 00 004	8	1/8	6	27,5	13	14	2
69485 00 005	8	1/4	8	29,5	15	14	2
69485 00 006	8	3/8	9	31,5	20	14	2
69485 00 007	10	1/4	8	34,5	16	19	2
69485 00 008	10	3/8	9	35,5	20	19	2
69485 00 009	12	3/8	9	35,5	20	22	2
69485 00 010	12	1/2	10	37,5	25	22	2



Temperature

min - 15 °C
max + 190 °C

69680

DADO

NUT
ÜBERWURFMUTTER
ECROU
TUERCA
PORCA

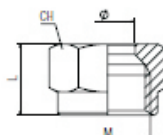

Code	Tube	L	CH	M	Pack.
69680 00 44 X1 L1	4 LL	11	10	M8x1	10
69680 00 44 X4 L1	6 LL	11,5	12	M10x1	10
69680 00 44 X7 L1	8 LL	12	14	M12x1	10
69680 00 44 X9 L1	10 L	15,5	19	M16x1,5	10
69680 00 44 Y1 L1	12 L	15,5	22	M18x1,5	10